

## Optical Termination Box (Indoor Use) FDB Series



FDB series are indoor wall mount type of optical termination box.

### Features

- A flexible termination box, capable of connecting optical cables, cordage, and adapters
- Suitable for network maintenance

### Application

- Indoor
- Wall mount

### Structure & Connection Type

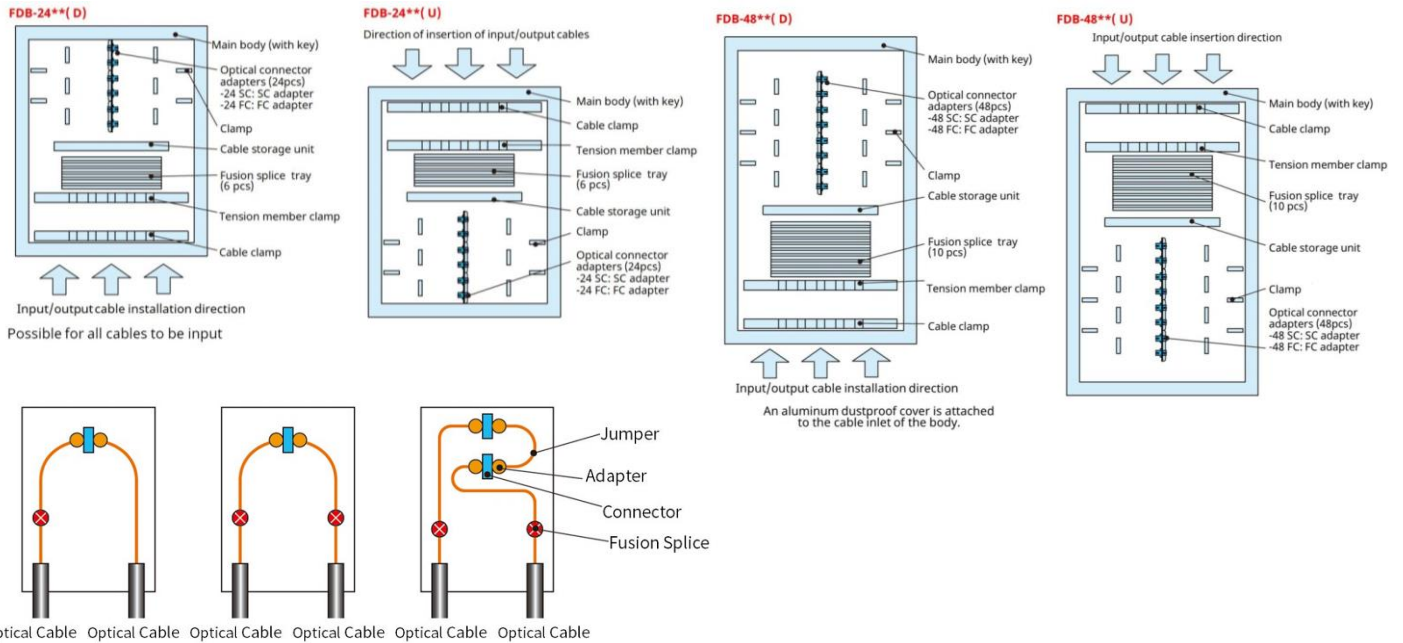

### Physical & Mechanical Characteristics

	FDB-24SC (U)	FDB-24SC (D)	FDB-48SC (U)	FDB-48SC (D)
Cable Installation Direction	Top	Bottom	Top	Bottom
Connection Type	SC connector (*1) and Fusion splice			
Number of Adapters	24		48	
Fiber Capacity	Single Fiber (0.25 mm)	60 fibers	100 fibers	
	Single Fiber (0.9 mm)	60 fibers	100 fibers	
	4 Fiber Ribbon	120 fibers	200 fibers	
Dimensions (mm)	W 500 x H 600 x D 160		W 500 x H 800 x D 160	
Mounting Hole Position (mm)	W 460 x H 480, 4 holes (Ø 10)		W 460 x H 680, 4 holes (Ø 10)	
Applicable Cable	Input	Round cable Ø 30 mm or less (1 pc)		
	Output	Round cable Ø 30 mm or less (4 pcs), 2 mm cord		
Weight (kg)	Approx. 25		Approx. 35	

\*1. FC connector type is available.



Contact us